

Manulife iFunds: A Quick Guide

How do I make a transaction?

You can manage your portfolio anytime, anywhere by logging into your Manulife InvestChoice account.

You can place your instructions by clicking on the menu button at the top right hand corner and select the transaction type you want.

Your Financial Planning Manager can always guide you through all of the required steps.

Redemption

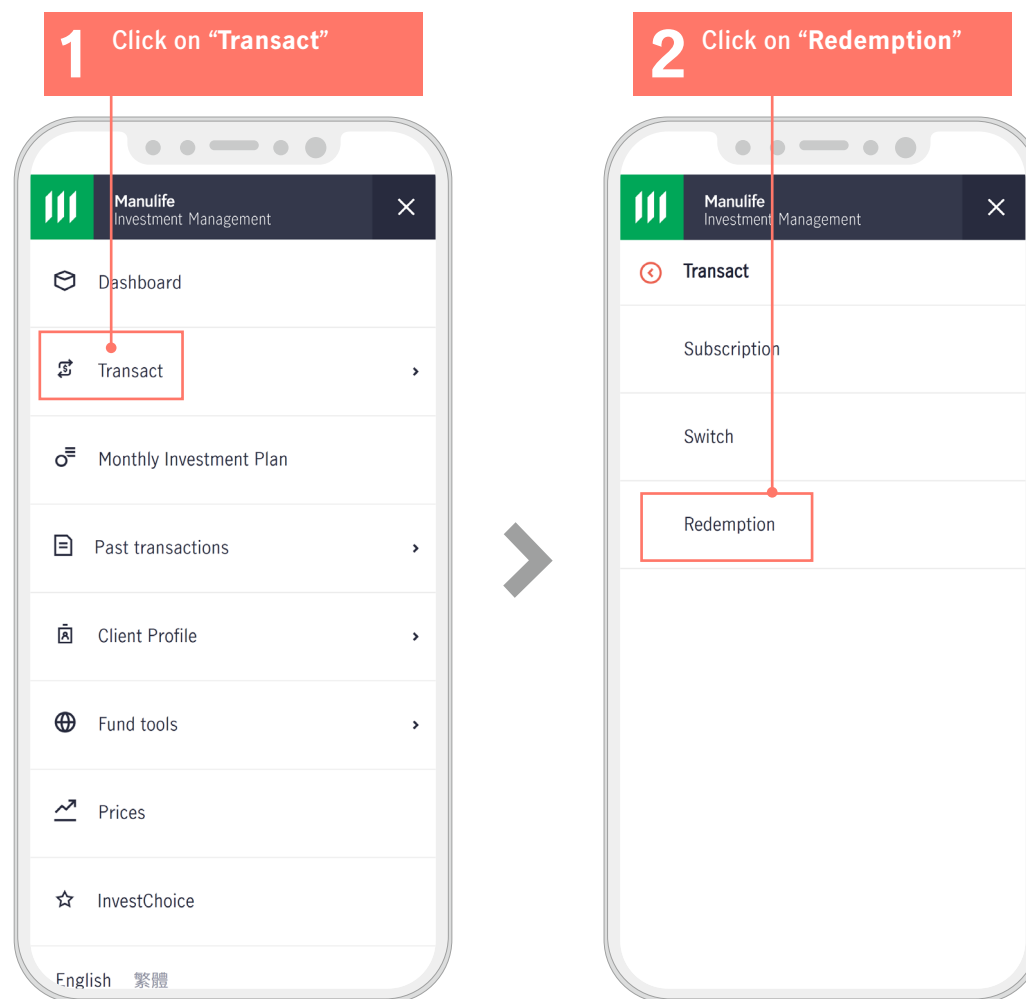

3 Review a list of your fund holdings then click on the fund you want to redeem

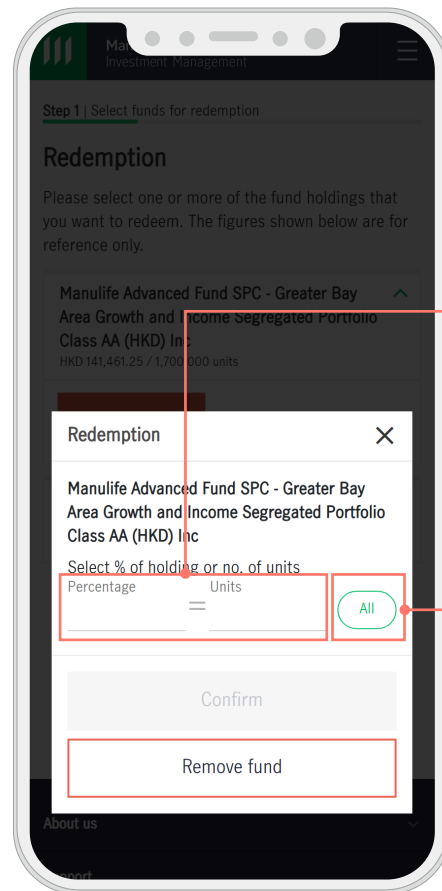
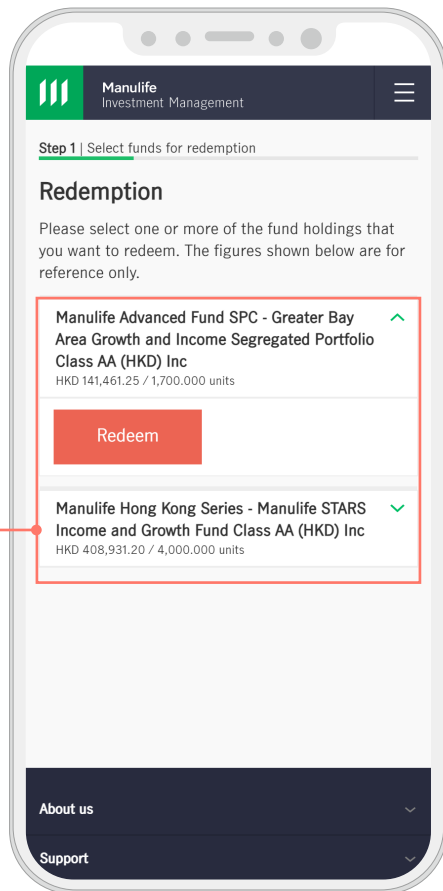

4 Enter the percentage or number of units to be redeemed

5 Click on "All" to redeem all units

6 Confirm your instructions and click on "Next"

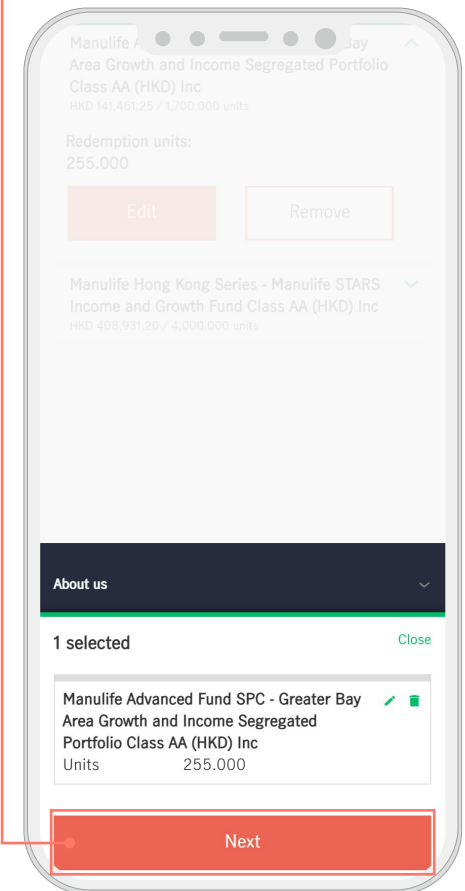

7 Select the currency you want for your redemption proceeds and click on "Next"

Step 2 | Payment options

Payment options

Please select the currency for receiving redemption proceeds. They will be deposited to the selected currency Cash Account of Manulife InvestChoice after settlement.

Deposit redemption proceeds in following currency
HKD

Next

Previous

About us

Support

8 Click on "Confirm" after reviewing all of the details and providing the necessary consent

Step 3 | Review and payment

Review

Please review the details below before submission of your instruction.

Account holder
Chan Tai Man

Account number
1030416990 (Trade-based Account (Single-name))

Payment currency
HKD

Redemption

Manulife Advanced Fund SPC - Greater Bay Area Growth and Income Segregated Portfolio Class AA (HKD) Inc
255.000 Units

Redemption charges not applicable, please refer to the [Fees and Charges](#) table for details.

Confirm

☐ I understand, certify and agree that I have read the above documents and other terms and conditions as it relates to the redemption of funds.

9 Receive a thank you page with a reference number

Your instruction is received

We have received your order and will carry out the necessary checks. A transaction notification will be sent by email and SMS. You can check the transaction history and status anytime in Manulife iFUNDS.

Reference number: HK-20220325-83638-1030416990

If you have any questions or concerns, please contact our [Customer Contact Centre](#)

Monday to Friday: 9:00am - 6:00pm
Closed on Saturday, Sunday and public holidays

Make another transaction

Transaction history

About us